

d1 js 16 pol	b k 11 pol	d2 H7 pol
2½	3/32 1/8 5/32 3/16 7/32 1/4	7/8
3	3/32 1/8 5/32 3/16 7/32 1/4	1
4	3/32 1/8 5/32 3/16 7/32 1/4	1¼
5	1/8 5/32 3/16 7/32 1/4 5/16	1¼
6	1/8 5/32 3/16 7/32 1/4 5/16	1¼
8	3/16 7/32 1/4 5/16 3/8	1½

d1 js 16 mm	b k 11 mm	d2 H7 mm
63	2,5 3 4 5	22
80	2,5 3 4 5 6	27
100	2,5 3 4 5 6	32
125	2,5 3 4 5 6	32
160	3 4 5 6	40
200	4 5 6	40

(HSS)



**1203**  
DIN 1834 B-N  
dentes retos

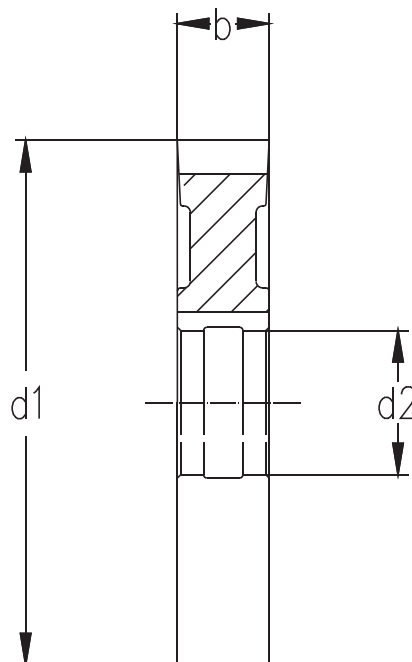

**1213**  
DIN 1834 A-N  
dentes cruzados, alternados  
ângulo de helice ~ 14°

**Fresa circular, corte 3 lados e dentado extra fino.**

**Ex. de especificação: 1203 - 63 x 3 x 22**